



RainPoint[®] Smart
More Than Water Saving

USER MANUAL

Wireless Pool Sensor

Model No. B0565T+HCS015T2H

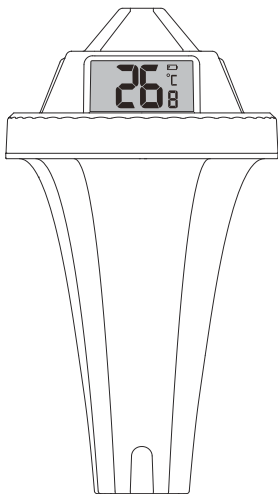

Welcome to the **RAINPOINT** family! Please read the manual before using to learn about the features and functions.

Contents

1. Contents in the box	01
2. Introduction	02
2.1 Product Overview	02
2.1.1 Receiver	02
2.1.2 Pool Sensor	03
2.2 Temperature And Humidity	03
3. Connection And Installation	04
3.1 Receiver Installation	04
3.2 Connect to pool Sensor	04
3.3 Low Battery Indicator	05
3.3.1 Receiver	05
3.3.2 Pool Sensor	05
4. Troubleshooting	06
5. Warranty Policy	07
6. FCC Statement	07
7. Customer Support	08

1. Contents in the box

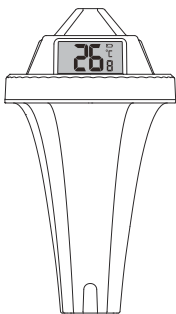

1

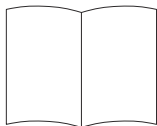

3



4



2

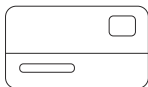

5

1. 1 X B0565T Receiver
2. 1 X HCS015T2H Pool Sensor
3. 1 X User Manual
4. 1 X Quick Guide
5. 1 X Warranty Card

2. Introduction

2.1 Product Overview

2.1.1 Receiver

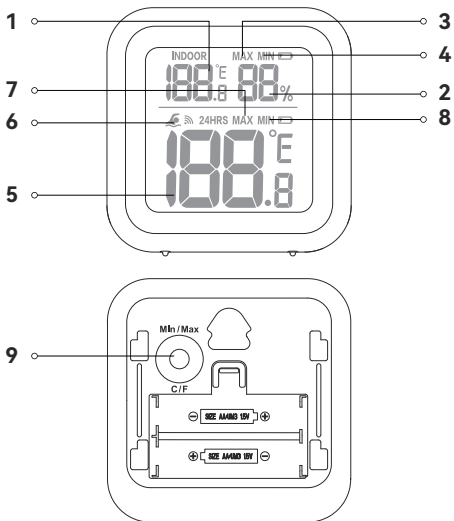

1. Indoor Temperature
2. Indoor Humidity
3. Max/Min Records of Indoor Temperature and Humidity
4. Low Battery Indicator of Receiver
5. Pool Temperature
6. Signal indication
7. Max/Min Records of pool thermometer in 24HRS
8. Low Battery Indicator of pool thermometer
9. Check Max/Min Records and change unit C/F
 - Press the button to check Max/Min temperature & humidity records.
 - Hold the button to select Celsius °C or Fahrenheit °F.

2.1.2 Pool Sensor

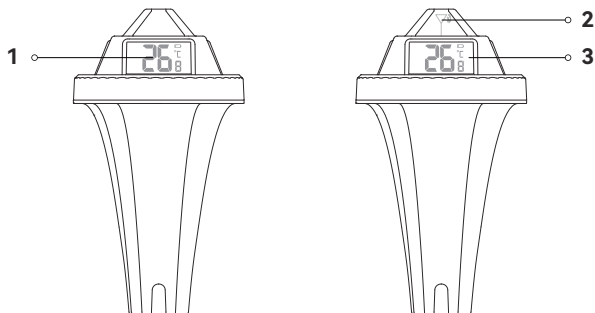

1. **LCD Display:** Pool Temperature
2. **The Antenna:** Transmit The Signa
3. **LED signal launch indicator:** Signal is launched every 3 minutes

2.2 Temperature And Humidity

1. **Receiver**
 - Indoor temperature range: 14°F ~ 122°F (-9.9°C ~ 60°C)
 - Indoor humidity range: 1% ~ 99%
2. **Pool thermometer**
 - Temperature range: 14°F ~ 122°F (-9.9°C ~ 50°C)

3. Connection And Installation

1. Please note the power-up sequencing.
The right approach: Please install the alkaline batteries for receiver firstly, then install the alkaline batteries for pool thermometer.
If not, pool thermometer may need more than 3 minute to connect with receiver.
2. Please use brand new alkaline batteries. Do not mix new batteries with old ones. Heavy metals and rechargeable batteries are not recommended.

3.1 Receiver Installation

Power on the Receiver with 2*AA alkaline batteries.
(Please take note of the battery polarity before inserting the batteries)

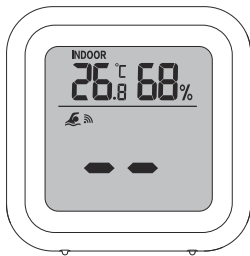
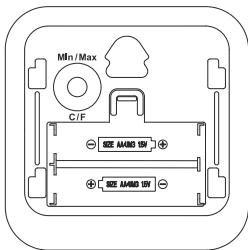

3.2 Connect to pool Sensor

Then power on the pool thermometer with 2*AA alkaline batteries and wait for auto pairing. (Please note the battery polarity before inserting the batteries)

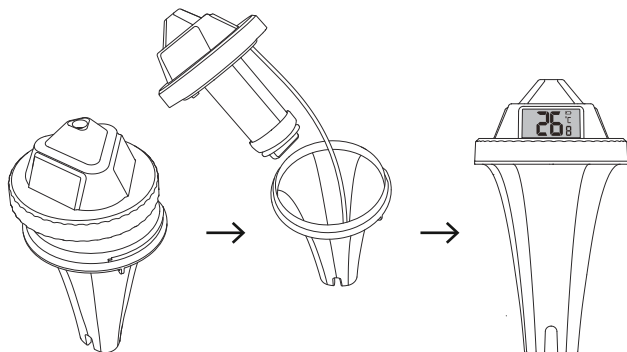

3.3 Low Battery Indicator

3.3.1 Receiver



1. When Battery Indicator shows next to the Indoor humidity replace batteries in your receiver.
2. When Battery Indicator shows next to the pool temperature, replace batteries in your pool thermometer

3.3.2 Pool Sensor

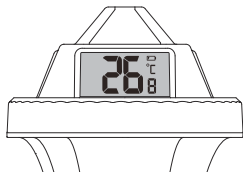

When Battery Indicator shows on the pool thermometer replace batteries.

4. Troubleshooting

Problem	Possible Solution
Pool thermometer signal is disconnected or showing dashes (- -) on the receiver.	<ul style="list-style-type: none">• Please remove and reinsert the pool thermometer batteries. If it still disconnected, please replace with new batteries and try again.• The maximum transmission range is 328ft/100m, move the receiver closer to the pool thermometer.• Make sure the receiver is placed at least 3ft/0.9m away from electronics that may interfere with the wireless communication, such as computers, TVs, microwaves, other wireless transmitters or other receivers, etc.
Inaccurate pool temperature readings on the receiver	When the temperature is inaccurate, it is often due to overpowered/under powered batteries. You can test the accuracy at you home. Side-by-side test: Bring the pool thermometer in the house and place it next to the receiver for 2 hours.
If the receiver or pool thermometer shows HH.H. or L.L.L.	Indicates that the temperature exceeds the minimum and maximum temperature range, our temperature range is 14°F~122°F (-9.9°C~ 50°C), in this case, please try to replace the battery, or contact us for device replacement.
The pool thermometer does not show a reading for more than 15 minutes, or suddenly does not show.	<ul style="list-style-type: none">• Replace the battery, pay attention to the polarity.• Need to check whether the pool thermometer is tightened, if it has been in the water, please contact us for replacement.

5. Warranty Policy

Thank you for choosing **RainPoint**. We provide 1-year limited warranty warranty on this product from the date of purchase.

If you have any problems with this product or during use, please don't hesitate to contact us.

6. FCC Statement

FCC ID: 2AWDB0565T, 2AWDBHCS015T2H

This device complies with Part 15 of the FCC Rules. Operation is subject to the following two conditions:

1. This device may not cause harmful interference.
2. This device must accept any interference received, including interference that may cause undesired operation.

FCC Warning: Any changes or modifications not expressly approved by the party responsible for compliance could void the user's authority to operate this equipment.

Note: This equipment has been tested and found to comply with the limits for a Class B digital device, pursuant to Part 15 of the FCC Rules. These limits are designed to provide reasonable protection against harmful interference in a residential installation. This equipment generates, uses, and can radiate radio frequency energy, if not installed and used in accordance with the instructions, may cause harmful interference to radio communications. However, there is no guarantee that interference will not occur in a particular installation. If this equipment does cause harmful interference to radio or television reception, which can be determined by turning the equipment off and on, the user is encouraged to try to correct the interference by one of the following measures:

- Reorient or relocate the receiving antenna.
- Increase the separation between the equipment and the receiver.
- Connect the equipment into an outlet on a circuit different from that to which the receiver is connected.
- Consult the dealer or an experienced radio/TV technician for help.

Note: The manufacturer is not responsible for any radio or TV interference caused by unauthorized modifications to this equipment. Such modifications could void the user's authority to operate the equipment.

7. Customer Support

If you find it difficult to set up and want to watch the setting tutorial video, please subscribe to our channel RainPoint on YouTube.



Or scan the QR code to visit the RainPoint channel on YouTube quickly.

If the app and the user manual don't have what you're looking for, and need some help about Rainpoint, please contact us by **LOT NO.:** XXXXXX (on the back of the device)



Made in China



Points de collecte sur www.quefairedemesdechets.fr
Privilégiez la réparation ou le don de votre appareil !

Need Help ?

Scan the QR code for more help.



or Email:

support@rainpointonline.com