



UV Fountain pump User manual

Model: UFP-1000, UFP-2000



WARNING

Please read the operating instructions and familiarize yourself with the equipment before placing it in service. Correct and safe use of the system requires strict compliance with the safety instructions. For safety reasons children and young people under 16 years of age, as well as people that cannot recognize potential hazards, or people that are not familiar with these instructions, may not use this device.

CAUTION

UFP series is UV clarify equipment which can be combined. It contains water pump and one piece of UV lamp, Any damage on the equipment or unmerited operation will bring dangerous radiation to the skin and eyes. So if there is any damage of the equipment, it can't be used any more. This equipment is not intend for use by person (including children) with reduced physical, sensory or mental capabilities, or lack of experience and knowledge, unless they have been given supervision or instruction concerning use of the equipment by a person responsible for their safety. The equipment should be placed out of reach to children. For the consideration of security, people

under 16 years old and those who can't identify danger or grasp the instruction can't use the equipment.

1. This equipment should be placed under the water. Be sure the equipment is submerged completely in the water and the depth should not be greater than 0.5M
2. When the water is not enough to submerge the equipment, please never connect power of the equipment to avoid running without water and cause damage.
3. As the UV lamp is made of quartz glass, please avoid drop of it or wallop on it.
4. Before all parts are installed completely, the equipment can't be plugged in
5. If there is any damage on the power cable, UV lamp or shell, the equipment can't be used. And it should be discarded as useless.
6. Please make sure that the electrical voltage, frequency used are consistent with the indication on the label of the equipment.
7. When installing the equipment, the installation regulation of pond pump should be followed.
8. The equipment should be earthed. And the professional person should check the condition of earthed. For the considered of safety, we advise customer to install leakage protector.
9. Pull the connecting cable is forbidden. And please keep the connecting cable away from heat, greasiness or sharpness.
10. When the pump have any unusual noise, please unplug to check the reason.
11. When know the frost is coming, please move away filter to avoid frost crack.
12. The dirtiness on the quartz glass tube will influence the effect of the equipment, please clean the quartz glass tube in time.
13. When the body sell is blocked with the sands and rubbish, it is possible to destroy the quartz glass tube and water pump. so please add the filter sponge to the inlet of the water. And the sponge should be cleaned timely (once a month).
14. UV is harmful to the eyes and skin. Please do not watch UV directly or let the skin approach to UV.
15. When install or repair this equipment, the electrical source of the equipment must be switched off.

INSTRUCTION

1. This equipment built-in filter sponge, filter material boxed, UV lamp and water pump. This equipment adopt reasonable water channel, suitable for both indoor, outside pond garden, aquatic breeding, clean water sterilization and water fountains.
2. Through the working of water pump, water flow from the filter cover to filter sponge, and then to the UV lamp. Inside of the UV lamp, the harmful bacteria and algae will be killed. Then the water flow to outside finally.
3. The UV lamp was designed as a closed device, no UV will scattering. And UV light 253.7nm will kill the harmful bacteria and algae to keep a good condition of water.

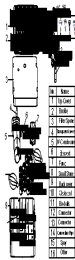

TECHNICAL PARAMETER

Model	Voltage	I or Power	UV Power	H-Max	Q-Max
UFP-1000	110-120V60H z	0.28A	9W	1.6M	1000L/H
UFP-2000	110-120V60H z	0.68A	13W	2.0M	2000L/H
UFP-1000	220-240V50H z	25W	9W	1.6M	1000L/H
UFP-2000	220-240V50H z	50W	11W	2.0M	2000L/H

INSTALLATION AND MAINTENANCE

Please switched off the electrical power when you clean the inside or change the UV pump. When clean the inside or change the UV lamp, please take below part list as your reference.

INSTALLATION

MAINTENANCE

Maintenance for filter sponge and filter material:

1. First ,anti-clockwise direction take off the fountain set, open the two clips on the side of the filter basket, then you can open the filter basket.
2. Take out the filter sponge and filter material boxes , clean and/or change these.(suggest clean the filter sponge every week)
3. if the bio ball is seriously polluted, it should be washed in the water in the pool,to preservation of microbial and biochemical properties on biochemical balls.

MAINTENANCE FOR UV-LAMP

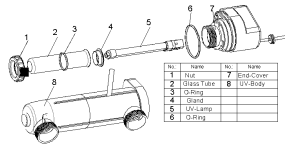

1. Take out the UV lamp for the unit, unload the screw and take out lamp holder.
2. Open the screw, turn the lamp holder and take out lamp holder components.

3. Remove the nut at the glass tube, take out the glass tube, allow UV light assembly and light bulb to cool and dry completely before handling. Once cool and dry, grip the base of the bulb with a dry cloth and gently pull the bulb from the assembly unit(do not pull on the bulb by gripping the grass element)

4. Slide new bulb into place until properly seated. Do not test UV light until the filter has been completely reassembled.

5. If you need to clean the quartz glass tube, please extract the glass tube , remove possible calcareous deposits on the tube using a suitable product. Then reassemble all the parts making sure that the o-rings and gaskets are correctly placed.

MAINTENANCE FOR PUMP

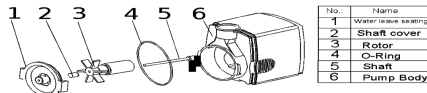

1. Take out the pump, turn impeller room in anti-clockwise direction till the block position, then you can separate the impeller room and pump body.

2. Take out the magnet rotor , clean all the parts with clean water and suitable brush.

STORAGE IN WINTER

1. Take out the equipment from water.
2. Clean the equipment thoroughly.
3. Check the parts and conditions of the equipment.
4. Keep this equipment in a area that free from frost. And in a container that with clean.

EASILY BROKEN PARTS

1. UV tube
2. Filter materials (bio-ball, gravel, filter sponge).

TROUBLE SHOOTING

Trouble	Reason	Solution
Water pump not work	<ul style="list-style-type: none"> ●No power ●Burn ●Impeller block ●Running without water 	<ul style="list-style-type: none"> ●Plug in ●Change water pump ●Clean the blocks ●Submersible the equipment under water ,then plug in again.
Water pump noisy	<ul style="list-style-type: none"> ●Something blocked in the impeller room or shaft broken 	<ul style="list-style-type: none"> ●Open the water pump and clean the blocks ●Change the shaft or shaft cover

	●Shaft or shaft cover wear	
Water pump lack of water	<ul style="list-style-type: none"> ●Impeller broken or water flow valve closed ●Equipment inlet blocked or water pump inlet blocked ●Lower voltage than requested 	<ul style="list-style-type: none"> ●Change the impeller set or open the water flow valve ●Clean the blocks ●Use suitable voltage
UV lamp not work	<ul style="list-style-type: none"> ●No power ●UV tube broken ●Connection of the UV tube not good 	<ul style="list-style-type: none"> ●Plug in ●Change UV tube ●Re-place the UV tube



DISPOSAL:

Do not dispose this product as unsorted municipal waste. Collection of such waste separately for special treatment is necessary. This product must not be disposed together with the domestic waste. This product has to be disposed at an authorized place for recycling of electrical and electronic appliances. By collecting and recycling waste, you help save natural resources, and make sure the product is disposed in an environmental friendly and healthy way.

Jebao Co.,Ltd

Tongmao Industrial Park, Dongsheng, Zhongshan, Guangdong. China.

Email:info@jebao.com

Website: www.jebao.com

Tel:+86-760-28136717/19/20

Fax:+86-760-28136725